

Technical data sheet



Product features

Cooking range solid top gas with static gas oven GN 2/1 - 5x burner

Model	SAP Code	00020538
--------------	-----------------	----------



- Device type: Gas unit
- Ignition: Piezo
- Protection of controls: IPX4

SAP Code	00020538	Power gas [kW]	42.400
Net Width [mm]	1200	Type of gas	Natural gas, propane butane
Net Depth [mm]	700	Width of internal part [mm]	657
Net Height [mm]	900	Depth of internal part [mm]	558
Net Weight [kg]	175.00	Height of internal part [mm]	308

Technical data sheet



Technical drawing

Cooking range solid top gas with static gas oven GN 2/1 - 5x burner

Model

SAP Code

00020538

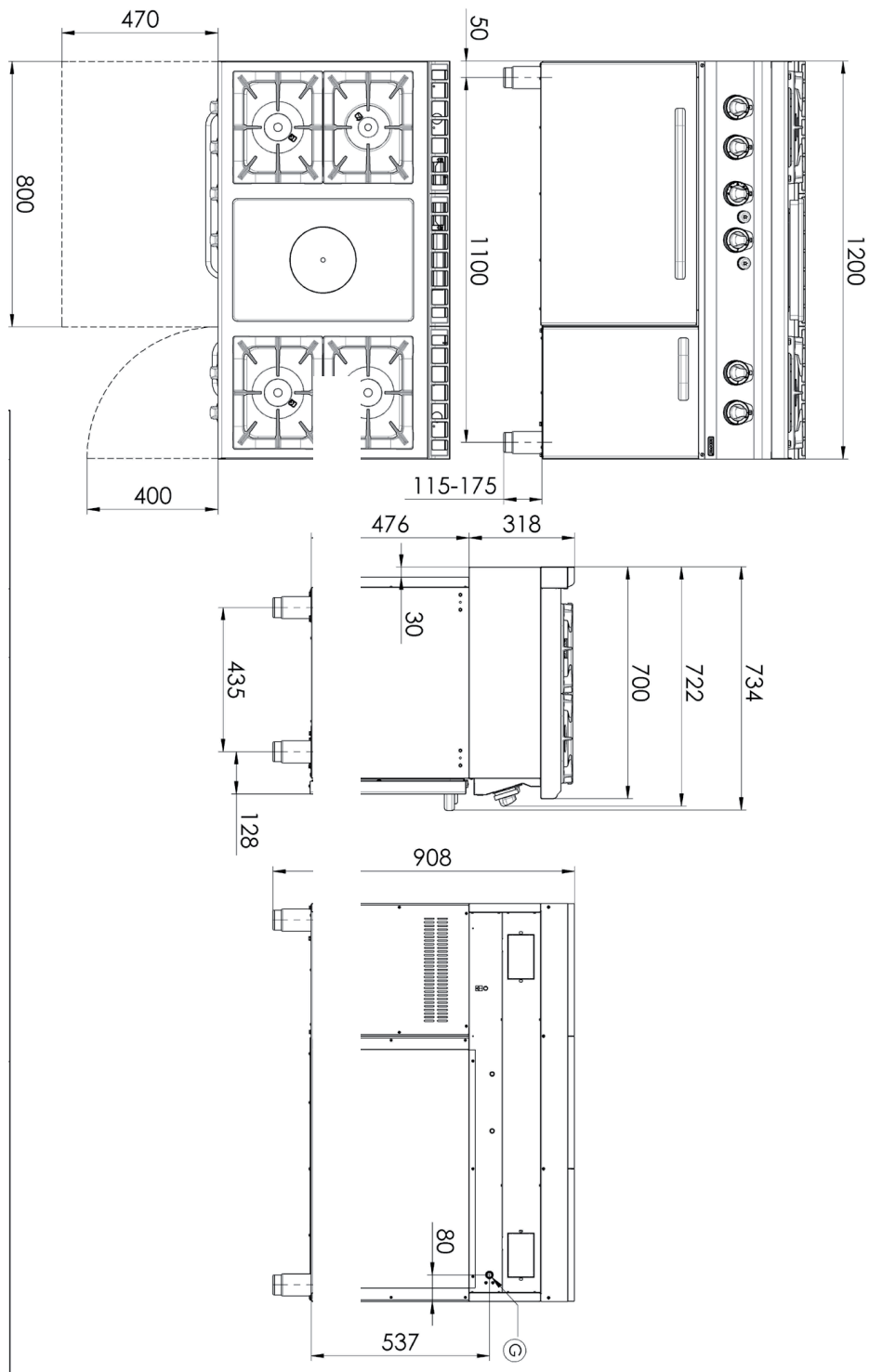

Technical data sheet



Technical parameters

Cooking range solid top gas with static gas oven GN 2/1 - 5x burner

Model	SAP Code	00020538
--------------	-----------------	----------

1. SAP Code:

00020538

2. Net Width [mm]:

1200

3. Net Depth [mm]:

700

4. Net Height [mm]:

900

5. Net Weight [kg]:

175.00

6. Gross Width [mm]:

1240

7. Gross depth [mm]:

800

8. Gross Height [mm]:

975

9. Gross Weight [kg]:

175.00

10. Device type:

Gas unit

11. Construction type of device:

With substructure

12. Power gas [kW]:

42.400

13. Ignition:

Piezo

14. Type of gas:

Natural gas, propane butane

15. Protection of controls:

IPX4

16. Indicators:

operation and warm-up

17. Worktop material:

AISI 304

18. Worktop Thickness [mm]:

1.20

19. Number of power control stages:

6

20. Safety thermocouple:

Yes

21. Number of burners/hot plates:

5

22. Type of gas cooking zones:

Fire protection to install + Classic burners

23. Burner type:

Brass, detachable

24. Oven Type:

gas static

25. Oven size:

GN 2/1

26. Oven material:

Stainless steel

27. Width of internal part [mm]:

657

28. Depth of internal part [mm]:

558

Technical data sheet



Technical parameters

Cooking range solid top gas with static gas oven GN 2/1 - 5x burner

Model	SAP Code	00020538
--------------	-----------------	----------

29. Height of internal part [mm]:

308

31. Minimum temperature of the inner chamber [°C]:

50

30. Maximum temperature of the inner chamber [°C]:

300